

D. 4 W. 263
C. 3 W. 79
Donation Lands

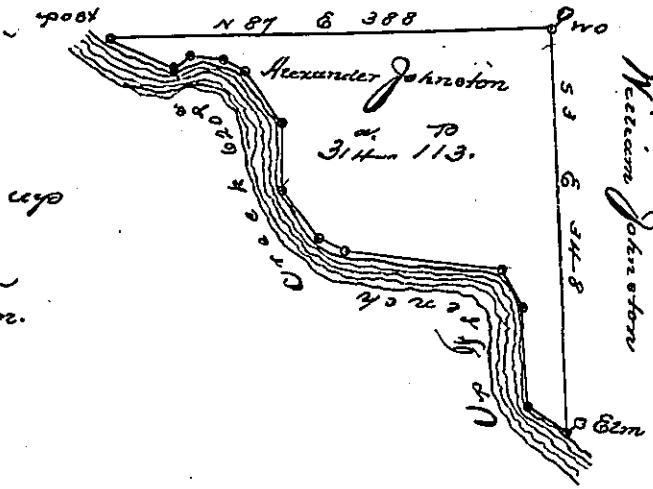

Courses and distances up French Creek

- Beginning at an Elm.*
- N. 54. W. 40.
 - N. 4. W. 84
 - N. 29. W. 40.
 - N. 85. W. 140.
 - N. 65. W. 22.
 - N. 11. W. 54.
 - North 56.
 - N. 39. W. 56.
 - N. 64. W. 20.
 - West 30.
 - S. 58 W. 14
 - N. 70 W. 64 post
- 620

The Draft of a Tract of Land situate in Venango County Insein Township on French Creek adjoining Donation Lands in the Fifth District and lands settled by William Johnston, containing Three hundred and four feet acres and one hundred and thirteen perches and allowance of six per Ch. Surveyed May 26th 1802, on Warrant granted to Alexander Johnston, dated the fifteenth day of December 1801.

Samuel Dale D.S.

*T. Daniel Cochran Esqr.
Surveyor General*

IN TESTIMONY that the above is a copy of the original remaining on file in the Department of Internal Affairs of Pennsylvania, made conformably to an Act of Assembly approved the 16th day of February, 1833, I have hereunto set my Hand and caused the Seal of, said Department to be affixed at Harrisburg, this first day of March, 1898

James M. Latta
Secretary of Internal Affairs.